

## ADDENDUM REPORT, DEVELOPMENT COMMITTEE. 19<sup>TH</sup> JULY 2018

Agenda item no	Reference no	Location	Proposal / Title
4.1	PA/18/00074	Lamb Court, 69 Narrow Street, London, E14 8EJ	Erection of a 4 storey building comprising 1 x 1b unit and 2 x 2b units above the proposed Reception and Concierge Area on the ground floor.

### 1.0 ADDITIONAL INFORMATION

- 1.1 The Council has received additional information regarding existing fire access for the residents of Lamb Court.
- 1.2 As shown in the below drawing there are 4 ground floor exits. 2 of which exit on to the Shoulder of Mutton Alley and 1 from Narrow Street

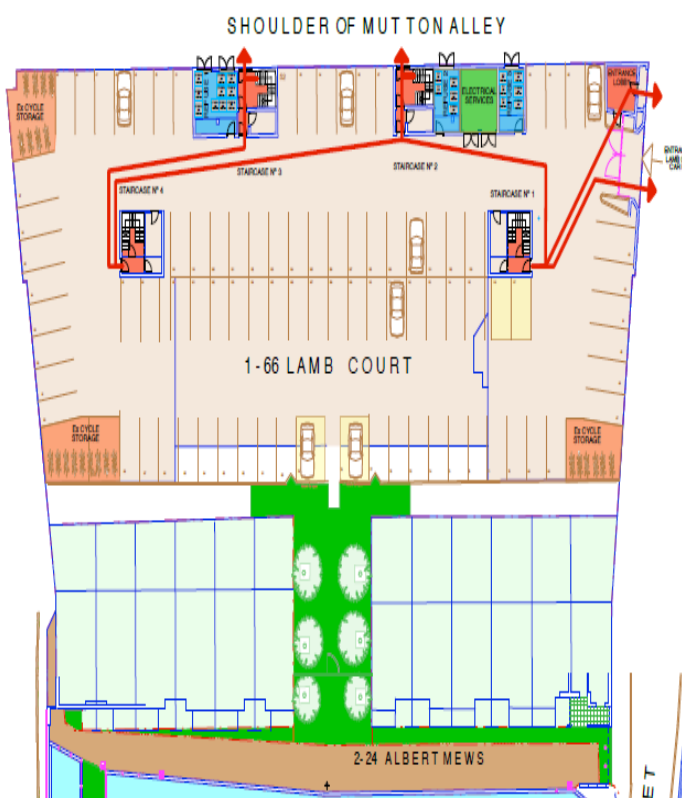

- 1.3 The proposed development impacts only access to Albert Mews. However 24 hour access for residents will be secured by condition for residents with either a concierge or a security code.
- 1.4 Sprinklers will also be installed and the proposal will comply with the relevant fire safety guidelines. It should be noted that the London Fire Authority have reviewed the application and have raised not objections.

### 2 RECOMMENDATION

- 2.1 Officer recommendation is to **GRANT** planning permission.